



**DR590-2CH IR**  
**DR590W-2CH IR**  
**User Guide**

**Infrared Interior Camera**

---

# BLACKVUE

---

DR590-2CH IR

DR590W-2CH IR

For manuals, customer support and FAQs go to [www.blackvue.com](http://www.blackvue.com)

## In the box

Check the box for each of the following items before installing the BlackVue dashcam.



Front camera



Infrared Interior/  
Rear camera



Power cord



Rear camera  
connection cable



microSD card  
adapter



microSD Card



Cable clips (5 EA)



User guide



External GPS  
(Optional)

### **Need help?**

Download the manual (including FAQs) and the latest firmware from **[www.blackvue.com](http://www.blackvue.com)**

Or contact a Customer Support expert at **[cs@pittasoft.com](mailto:cs@pittasoft.com)**

The DR590-2CH IR and DR590W-2CH IR models use the same firmware as the DR590-2CH and DR590W-2CH models, respectively.

## ➤ At a glance

The following diagrams explain each part of the Infrared interior camera.

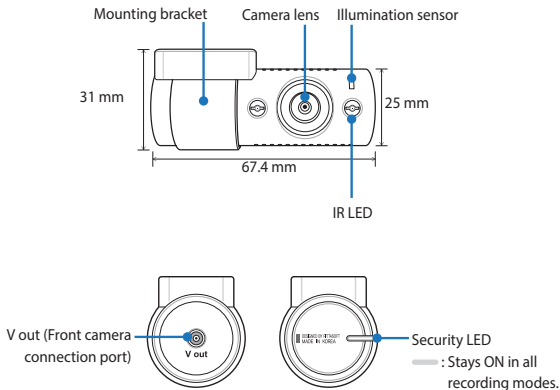

The illumination sensor detects when it is dark and activates the IR LEDs for optimal interior recording.

## STEP 1 Install and power up

Install the front camera behind the rear view mirror. Install the Infrared interior camera at the top of the front or back windshield.

Front camera



Infrared interior camera



### Warning

- Do not install the product in a location where it can obstruct the driver's field of vision.



Turn off the engine. Open the cover of the microSD card slot, gently push the card into the slot until it locks into place and close the cover.

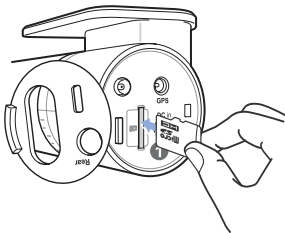

- B** Peel off the protective film from the double-sided tape and attach the front camera to the windshield behind the rear-view mirror.

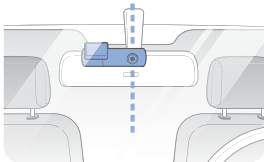
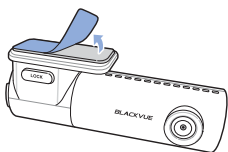

- B-1** **Optional GPS receiver:** Plug in the GPS receiver and attach it in a corner of the windshield. Tuck the cable into the windshield trim using the pry tool.

- C** Adjust the angle of the lens by rotating the body of the front camera. We recommend pointing the lens slightly downwards ( $\approx 10^\circ$  below horizontal), so as to record video with a 6:4 road to background ratio.

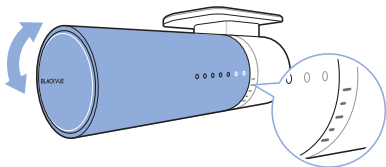

- D** Peel off the protective film from the double-sided tape and attach the Infrared interior camera to the front or rear windshield. Adjust the angle of the lens by rotating the body of the camera.

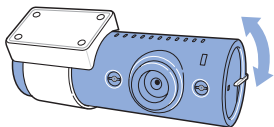

- E** Connect the front camera ('Rear' port) and the rear camera ('V out') using the rear camera connection cable.

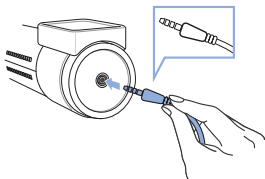
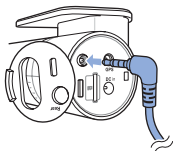

- F** Use the pry tool to lift the edges of the rubber window sealing and/or molding and tuck in the rear camera connection cable.
- G** Plug the power cord into the cigarette lighter socket and the front camera.
- H** Use the pry tool to lift the edges of the windshield trim/molding and tuck in the power cord.



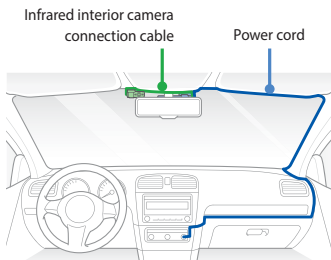

- ① Turn on the engine. The BlackVue dashcam will power up and start recording. Video files are stored on the microSD card. When the microSD card fills up, the newest video files will start to replace the oldest video files (called **loop recording**) – so you will always have the most recent video files.



### Note

- There are 3 recording modes: Normal, Event and Parking. The dashcam starts recording in normal mode, switches to event mode when an impact is detected, and switches to parking mode if the vehicle is stationary for 5 minutes. For parking mode recording, a Parking Mode Battery Pack (Power Magic Battery Pack) or a Parking Mode Hardwiring Kit (Power Magic Pro) is required.
- When you run the dashcam for the first time the firmware is automatically loaded onto the microSD card. After the firmware has been loaded onto the microSD card you can customize settings using BlackVue Viewer on a computer.

## Product specifications

### DR590-2CH IR

<b>Model Name</b>	DR590-2CH IR
<b>Color/Size/Weight</b>	Front: Black / Width 111.8 mm x Height 34 mm / 63g Rear: Black / Width 67.4 mm x Height 25 mm / 21g
<b>Memory</b>	microSD Card (16 GB / 32 GB / 64 GB / 128 GB)
<b>Recording Modes</b>	Normal Recording, Event Recording (when impact is detected in normal and parking mode) and Parking recording (when motion is detected) * For parking mode recording, a Parking Mode Battery Pack (Power Magic Battery Pack) or a Parking Mode Hardwiring Kit (Power Magic Pro) is required.
<b>Camera</b>	Front: STARVIS™ CMOS Sensor (Approx. 2.1 megapixels) Rear: CMOS Sensor (Approx. 2 megapixels)
<b>Viewing Angle</b>	Front: Diagonal 139°, Horizontal 116°, Vertical 61° Rear: Diagonal 140°, Horizontal 115°, Vertical 60°
<b>Resolution/Frame Rate</b>	<Front - Rear> Full HD (1920x1080) @ 30 fps - Full HD (1920x1080) @ 30 fps Full HD (1920x1080) @ 30 fps - HD (1280x720) @ 30 fps HD (1280x720) @ 30 fps - HD (1280x720) @ 30 fps
<b>Image Quality</b>	Highest, High, Normal
<b>Video Compression Mode</b>	MP4
<b>GPS</b>	External (optional)
<b>Microphone</b>	Built-in
<b>Speaker (Voice Guidance)</b>	Built-in
<b>LED Indicators</b>	Front: Recording LED, GPS LED, Wi-Fi LED, Front Security LED Rear: Rear Security LED

<b>Wavelength of Interior camera IR light</b>	940 nm (2 Infrared (IR) LEDs)
<b>Button</b>	Short press: Mic on/off Press and hold: Format microSD card
<b>Sensors</b>	3-Axis Acceleration Sensor
<b>Backup Battery</b>	Built-in super capacitor
<b>Input Power</b>	DC 12 V – 24 V (DC Plug:  (Ø3.5 x Ø1.35), MAX 1 A /12 V)
<b>Power Consumption</b>	Avg. 290mA (3.60W at 12V, when there is no external GPS receiver) Avg. 310mA (3.84W at 12V, when an external GPS receiver is connected) * Approx. 60mA increase in current when IR LEDs are ON. * Actual power consumption may vary depending on use conditions and environment.
<b>Operation Temperature</b>	-20°C – 70°C (-4°F – 158°F)
<b>Storage Temperature</b>	-20°C – 80°C (-4°F – 176°F)
<b>High Temperature Cut-Off</b>	Approx. 80°C (176°F)
<b>Certifications</b>	FCC, CE, RoHS
<b>Software</b>	BlackVue Viewer * Windows XP or higher and Mac Yosemite OS X (10.10) or higher
<b>Other Features</b>	Adaptive Format Free File Management System

\*STARVIS is a trademark of Sony Corporation.

## □ DR590W-2CH IR

<b>Model Name</b>	DR590W-2CH IR
<b>Color/Size/Weight</b>	Front: Black / Width 111.8 mm x Height 34 mm / 64g Rear: Black / Width 67.4 mm x Height 25 mm / 21g
<b>Memory</b>	microSD Card (16 GB / 32 GB / 64 GB / 128 GB)
<b>Recording Modes</b>	Normal Recording, Event Recording (when impact is detected in normal and parking mode) and Parking recording (when motion is detected) * For parking mode recording, a Parking Mode Battery Pack (Power Magic Battery Pack) or a Parking Mode Hardwiring Kit (Power Magic Pro) is required.
<b>Camera</b>	Front: STARVIS™ CMOS Sensor (Approx. 2.1 megapixels) Rear: CMOS Sensor (Approx. 2 megapixels)
<b>Viewing Angle</b>	Front: Diagonal 139°, Horizontal 116°, Vertical 61° Rear: Diagonal 140°, Horizontal 115°, Vertical 60°
<b>Resolution/Frame Rate</b>	<Front - Rear> Full HD (1920x1080) @ 30 fps - Full HD (1920x1080) @ 30 fps Full HD (1920x1080) @ 30 fps - HD (1280x720) @ 30 fps HD (1280x720) @ 30 fps - HD (1280x720) @ 30 fps
<b>Image Quality</b>	Highest, High, Normal
<b>Video Compression Mode</b>	MP4
<b>Wi-Fi</b>	Built-in (802.11n (2.4 – 2.4835 GHz))
<b>GPS</b>	External (Optional)
<b>Microphone</b>	Built-in
<b>Speaker (Voice Guidance)</b>	Built-in
<b>LED Indicators</b>	Front: Recording LED, GPS LED, Wi-Fi LED, Front Security LED Rear: Rear Security LED
<b>Wavelength of Interior camera IR light</b>	940 nm (2 Infrared (IR) LEDs)

<b>Button</b>	Short press: Wi-Fi on/off Press and hold: Format microSD card
<b>Sensors</b>	3-Axis Acceleration Sensor
<b>Backup Battery</b>	Built-in super capacitor
<b>Input Power</b>	DC 12 V – 24 V (DC Plug:  (Ø3.5 x Ø1.35), MAX 1 A /12 V)
<b>Power Consumption</b>	Avg. 300mA (3.60W at 12V, when Wi-Fi is off and no external GPS receiver is connected) Avg. 350mA (4.2W at 12V, when Wi-Fi is on and an external GPS receiver is connected) * Approx. 60mA increase in current when IR LEDs are ON. * Actual power consumption may vary depending on use conditions and environment.
<b>Operation Temperature</b>	-20°C – 70°C (-4°F – 158°F)
<b>Storage Temperature</b>	-20°C – 80°C (-4°F – 176°F)
<b>High Temperature Cut-Off</b>	Approx. 70°C (158°F)
<b>Certifications</b>	FCC, CE, RoHS, Telec, WEEE, IC
<b>Software</b>	BlackVue Viewer * Windows XP or higher and Mac Yosemite OS X (10.10) or higher
<b>Application</b>	BlackVue Application (Android 4.4.2 or higher, iOS 8.0 or higher)
<b>Other Features</b>	Adaptive Format Free File Management System

\*STARVIS is a trademark of Sony Corporation.

The DR590-2CH IR and DR590W-2CH IR models use the same firmware as the DR590-2CH and DR590W-2CH models, respectively, and have all of the same great features. For more information about using the DR590-2CH IR or DR590W-2CH IR, please download the DR590-2CH or DR590W-2CH manual from [www.blackvue.com](http://www.blackvue.com) > Support > Downloads.

## Notes

## Notes



**Product** | Car Dashcam  
**Model Name** | DR590-2CH IR, DR590W-2CH IR  
**Manufacturer** | Pittasoft Co., Ltd. / South Korea  
**Address** | 7F, BYC HIGHCITY Building A 131, Gasan Digital 1-ro, Geumcheon-gu,  
Seoul, Republic of Korea, 08506  
**Customer Support** | [cs@pittasoft.com](mailto:cs@pittasoft.com)  
**Product Warranty** | One-Year Limited Warranty  
 [facebook.com/BlackVueOfficial](https://facebook.com/BlackVueOfficial)  
**[www.blackvue.com](http://www.blackvue.com)**  
**Made in Korea**

---